

Spit Buildex Teks Self Drilling Steel Screws

The original self-drilling, self-tapping screw for fastening various materials to steel. Teks Screws drill, tap and fasten in-one operation.



Teks Screw Installed

Substrate

- Steel

Applications

- Steel framing systems
- Brick ties
- Bracketry to steel
- Flashing
- Composite panels
- Wind posts

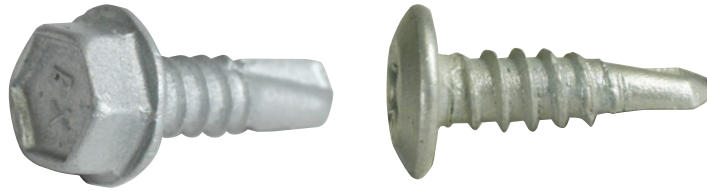
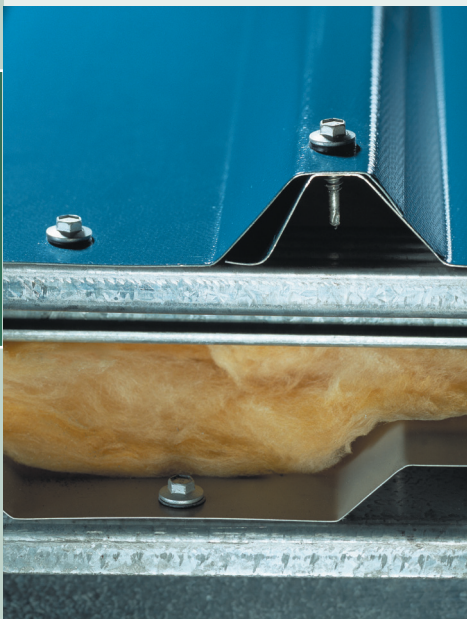

Features and Advantages

- No hole alignment issues
- High clamping action
- Eliminates the need for costly drill bits
- The integral washer on Maxiseal prevents water ingress and reduces bimetallic corrosion
- High thread on Maxiseal MXHT supports the outer sheet of composite panels
- Maximum pullover performance
- Excellent driving stability
- Point to thread design maximises pullout performance
- Non walking point provides fast material engagement
- Seals when driven at an angle - Maxiseal 1 - 2°
- Sharp convex drill point has precise cutting edges to improve drill performance with less effort
- Climaseal finish provides excellent corrosion resistance and lower tapping torque



Integral Washer



High Thread on Maxiseal MXHT

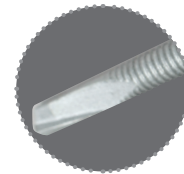

Sharp convex drill point



Climaseal finish

Accessories

Eurocode	Description	Qty
921557	Magnetic Nut Setter Hex 6.5mm (1/4" hex drive)	1
921469	Magnetic Nut Setter Hex 8mm (1/4" hex drive)	1
921100	PSD 2-2 Square Drive Bit	1
921098	Phillips N° 2 Bit	1
921099	Phillips N° 3 Bit	1

Teks Screws - For General Components to Steel



Eurocode	Description	Head Style	Diameter	Length	Steel Thickness	Effective Thread Length	Box Qty
921185	PH14	Pan head	4.8mm	14mm	0.9 - 4.0mm	4mm	200
920026	TC13	5 / 6" AF HEX	4.8mm	13mm	0.9 - 4.0mm	4mm	500
920027	TC16	5 / 6" AF HEX	4.8mm	16mm	0.9 - 4.0mm	6mm	500
920028	TC25	5 / 6" AF HEX	5.5mm	25mm	0.9 - 5.0mm	8mm	500
920126	TC50	5 / 6" AF HEX	5.5mm	50mm	0.9 - 5.0mm	42mm	100
920127	TC62	5 / 6" AF HEX	5.5mm	62mm	0.9 - 5.0mm	51mm	200
921199	TC75	5 / 6" AF HEX	5.5mm	75mm	0.9 - 5.0mm	65mm	100
920125	TC100	5 / 6" AF HEX	5.5mm	100mm	0.9 - 5.0mm	90mm	50
921202	TL32	5 / 6" AF HEX	5.5mm	32mm	3.0 - 12.5mm	12mm	200
921203	TL38	5 / 6" AF HEX	5.5mm	38mm	3.0 - 12.5mm	18mm	200
920128	TL50	5 / 6" AF HEX	5.5mm	50mm	3.0 - 12.5mm	30mm	200
921205	TS20	5 / 6" AF HEX	4.8mm	20mm	0.5 - 2.0mm	5mm	200

Teks Screws - For Standing Seam and Clip Fixing Systems



Eurocode	Description	Head Style	Diameter	Length	Steel Thickness	Drive type	Box Qty
921259	CFC16	Low Profile	4.8mm	16mm	0.9 - 4.0mm	P2	200
921165	CFC24	Pancake	4.8mm	25mm	0.9 - 4.0mm	P2	250
921166	CFC26	Pancake	5.5mm	25mm	0.9 - 4.0mm	2PSD	250
921260	CFL32	Low Profile	5.5mm	32mm	4.0 - 12.5mm	P3	500
921167	CFW26	Pancake	4.8mm	25mm	23mm timber emb.	P2	500

Maxiseal Composite Panel Screw



Eurocode	Description	Head Style	Diameter	Length	Steel Thickness	Build-up Range	Box Qty
921182	MXHT60	5/16" HEX H/D	5.5mm	60mm	0.9 - 5.0mm	25 - 42	200
921551	MXHT80	5/16" HEX H/D	5.5mm	80mm	0.9 - 5.0mm	45 - 62	200

Maxiseal Stitching Screw



Eurocode	Description	Head Style	Diameter	Length	Steel Thickness	Box Qty
921262	MXS16	5/16" HEX H/D	4.8mm	16mm	0.5 - 2.5mm	500
921277	MXS25		6.0mm	25mm	0.5 - 2.5mm	100

Maxiseal for Cladding Applications



MXL MXC

Eurocode	Description	Head Style	Diameter	Length	Steel Thickness	Box Qty
921183	MXL38	5/16" HEX H/D	5.5mm	38mm	3.0 - 12.5mm Heavy Gauge	200
920023	MXC26	5/16" HEX H/D	5.5mm	26mm	0.9 - 5.0mm Light Gauge	250
920024	MXC32	5/16" HEX H/D	5.5mm	32mm	0.9 - 5.0mm Light Gauge	250

Washers and Tonex Colour Caps



Eurocode	Description	Box Qty
921286	16SS - 16mm Ø Stainless Steel Washer	500
921287	19SS - 19mm Ø Stainless Steel Washer	500
921285	BX1 - 10A05 Goosewing grey colour cap for 5 / 16" Hex Tek	1,000