

# Spit Hollow Wall Anchor Pre-assembled Cavity Fixing

**Pre-assembled cavity fixing. Locks into the base material allowing removal and refit of fixture with demountable screw.**

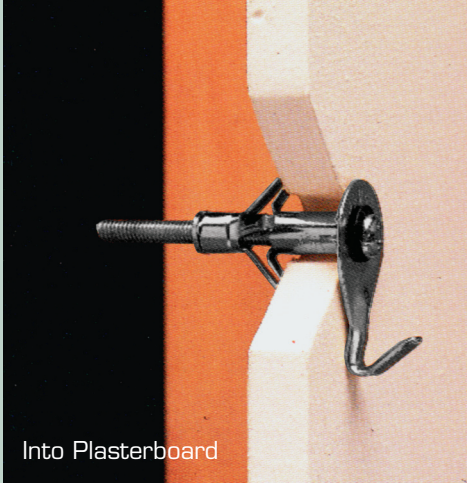

Into Plasterboard

## Substrates

- Plasterboard

## Applications

- Bathroom fixtures
- Kitchen fixtures
- Shelving brackets
- Ceiling fixtures



## Available in bag packaging:

- Sizes available:
- M4 x 46mm (567052)
  - M5 x 45mm (567053)
  - M5 x 59mm (567054)
  - M6 x 59mm (567055)

See page 165 for further details on the bag range.

## Features and Advantages

- **Flush finish low profile head**
- **Large flange** - Prevents pull into base material
- **Anti-rotation barbs** - Prevent the anchor from spinning in the hole
- **5 expansion legs** - Give full support (M5 and M6)

## Technical Specification

Anchor for hollow base materials. For correct setting use the setting tool to ensure that the legs collapse fully, to spread the load over a wide area.

### Material

Pressed steel body - Zinc plated 5µm  
Machined screw - Zinc plated 5µm

## Installation

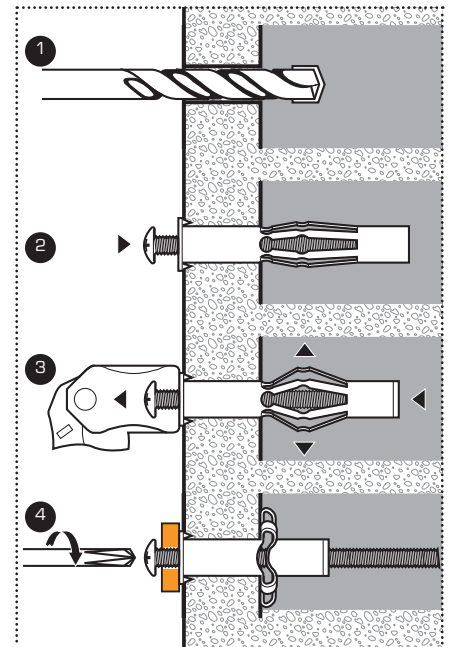

## Hollow Wall Anchor

	Eurocode	Thread Ø	Overall Anchor Length	Drill Bit Size	Wall Thickness (Max/Min)	Max Fixture Thickness	Box Qty
	061030	M4	23mm	8mm	0 - 6mm	10 - 15mm	100
	061040	M4	33mm	8mm	0 - 13mm	10 - 20mm	100
	061050	M4	46mm	8mm	0 - 24mm	10 - 20mm	100
	061070	M5	34mm	8mm	0 - 14mm	10 - 20mm	100
	061080	M5	45mm	8mm	0 - 16mm	10 - 25mm	100
	061090	M5	59mm	8mm	0 - 32mm	10 - 25mm	100
	061120	M6	46mm	10mm	0 - 16mm	10 - 25mm	100
	061130	M6	59mm	10mm	0 - 30mm	10 - 25mm	100

## Hollow Wall Anchor Setting Tool



Eurocode	Description	Box Qty
318600	Hollow Wall Anchor Setting Tool	1